

Smart Banking Solution

Building the future banks

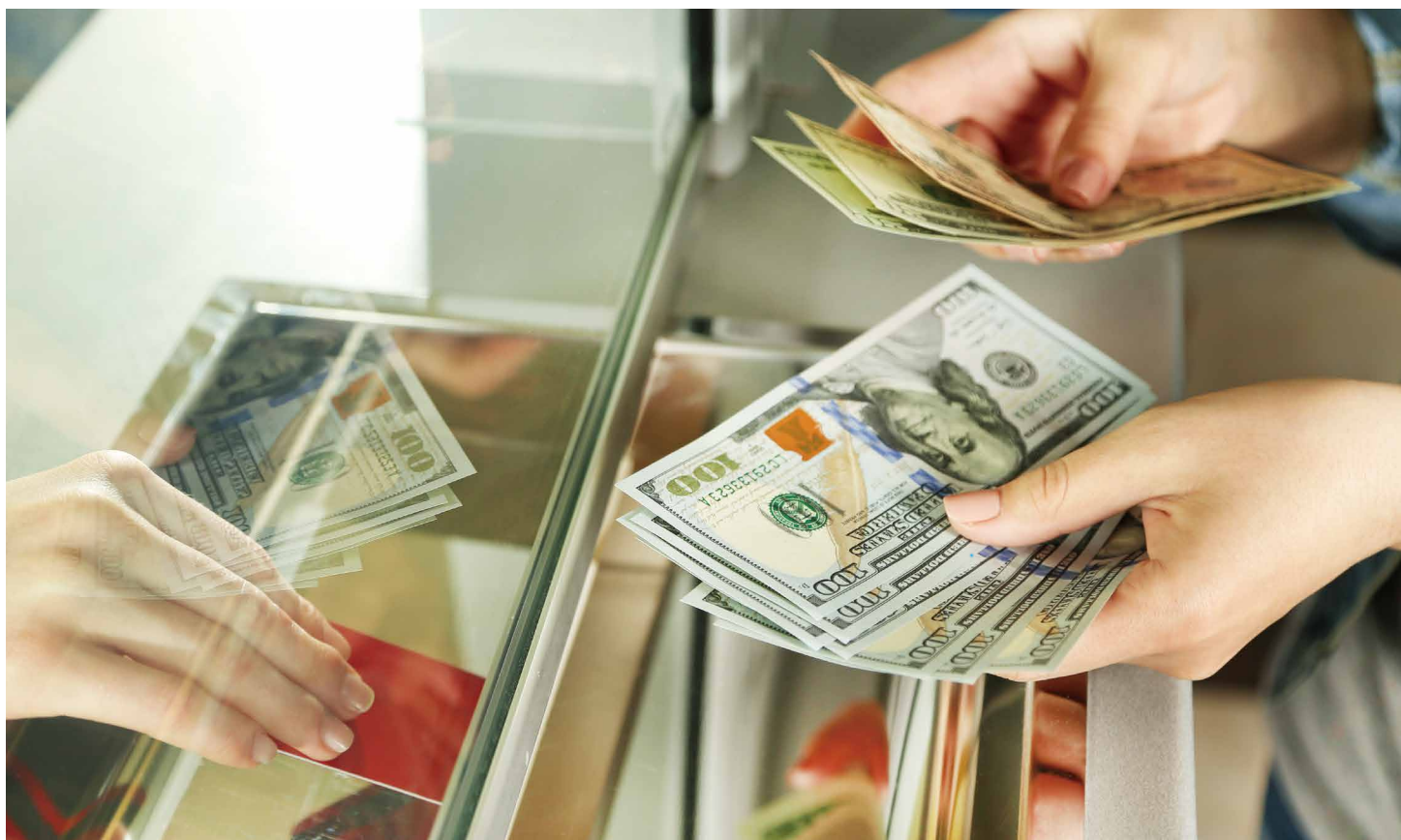

Proactive Security



Intelligent Analysis



Business Transformation

Challenges



Enhance Security

- Early warning of incidents ensuring proactive security
- Robust UHD surveillance guarantees round the clock surveillance without any blind spots
- Integrated security system works in unison ensuring state of the art security for your bank



Control Risks

- Ensuring compliance regulation for bank branch operation
- Monitor your ATM machines and detect foreign objects installation to prevent high tech crimes
- Use audio / video recorded conversation at cash handling and non - cash handling counters to avoid any potential business dispute cases



Optimize Business Operation

- Remote monitor bank branch operation
- Use customer flow data, demographic data, and regional people counting data for precision marketing and operation decision making
- Recognize VIP customers and provide special attention to improve their banking experience

Solution Overview

Counter

- Record Customer - Teller interactions to avoid business disputes
- Monitor customer service satisfaction



ATM

- Protect people and property from external attack
- Remotely assist ATM users in case of emergency



Lobby

- 360 degree monitoring of entire lobby area
- Queue length and time monitoring
- Precision marketing based intelligent ad publishing

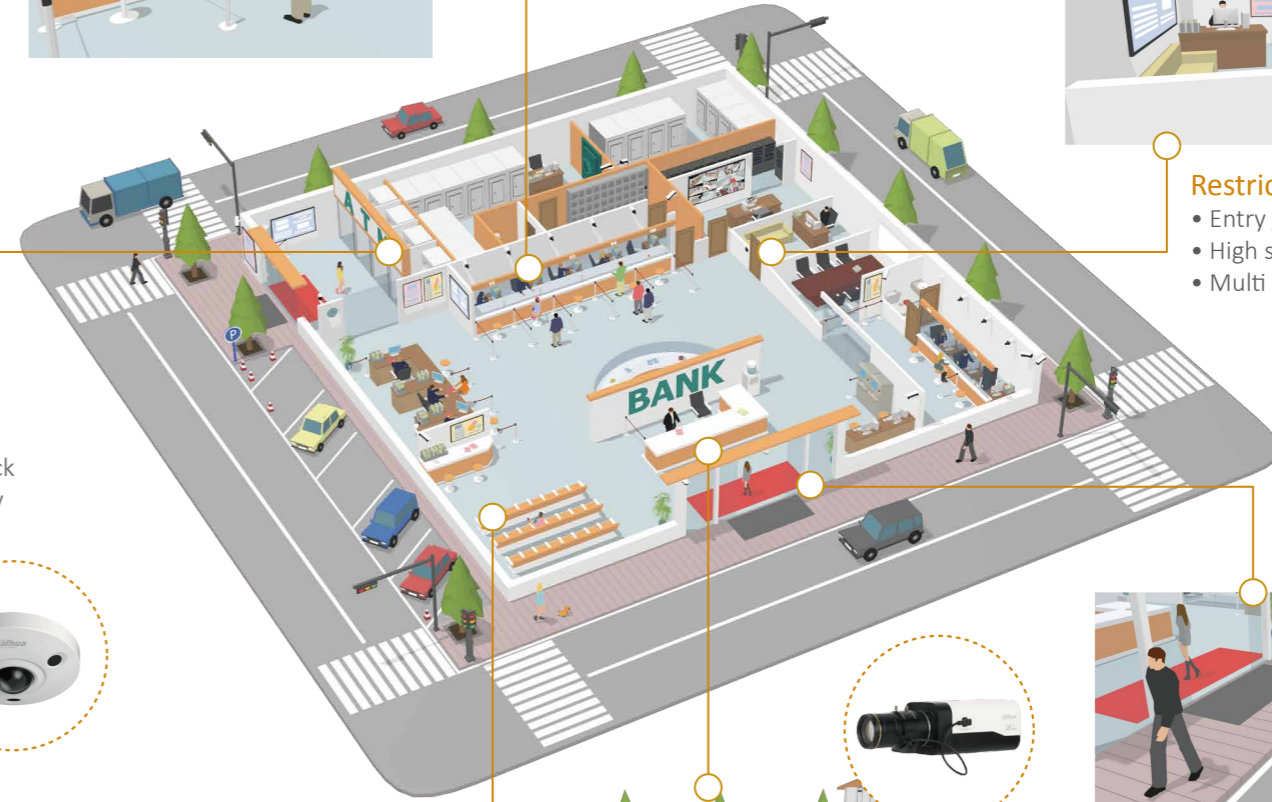

Restricted Area

- Entry / Exit log
- High security risk
- Multi - level security authorization



Outdoor

- Bank's surrounding security, including parking areas and sidewalks
- Rapidly changing light condition requires high - definition, ultra wide range, Starlight technology



Entrance

- Facial Recognition
- People counting for branch operation optimization

System Topology

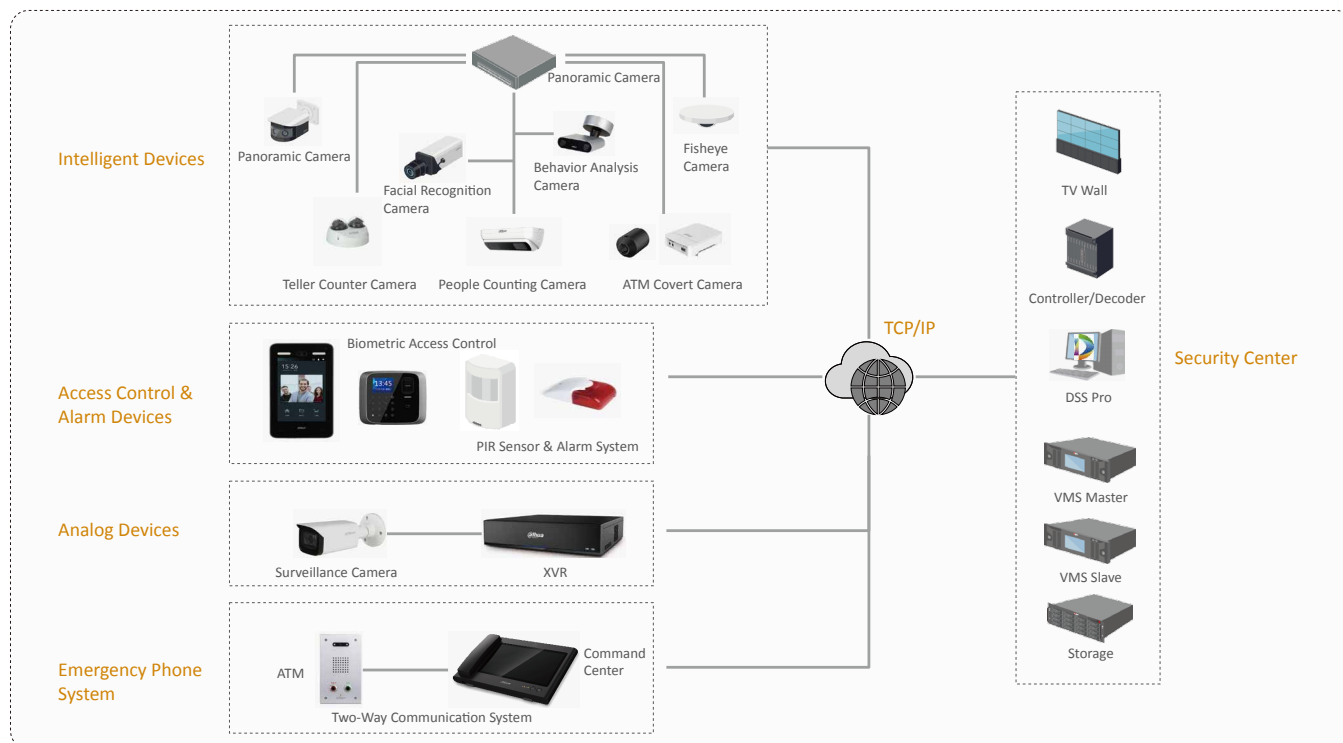

Highlights

- Ultra High Definition**
 4K UHD with IR and starlight feature supports dynamic application scenario surveillance; improve image quality greatly.
- Intelligent Application**
 Supports various intelligent applications such as facial recognition, behavior analysis, queue management, people counting, heat map, ANPR, POS/ATM integration and overlay.
- Unified Integration**
 Easy to integrate and manage different devices such as access control, intelligent camera, analog camera, alarm systems, ATM pinhole cameras, emergency phone system in a single platform.
- System & Data Safety**
 Real - time monitoring of device health and network status, to prevent video loss, ensures a foolproof surveillance solution.
- High Cost-Efficiency**
 Multi - function products, reuse the existing cable and easy to install, low overall investment costs and maintenance cost, greatly reduces TCO.

* Design and specifications are subject to change without notice.

Ver. 1, Oct. 2019

DAHUA TECHNOLOGY

No.1199 Bin'an Road, Binjiang District, Hangzhou, China. 310053
 Tel: +86-571-87688883 Fax: +86-571-87688815
 Email: overseas@dahuatech.com
 www.dahuasecurity.com

